

General

Chain Driven Power Belt Spiral with a Belt Outside Radius C of 87" ($BF + IR$), especially designed to convey heavy products safely and reliably in an industrial environment such as in the material handling industry, distribution centers, manufacturing industry or airports.

- Tapered End Rollers
- Simple, Efficient and Reliable Design
- Rugged Steel Construction
- Low Maintenance Requirements
- Low Noise Operation
- Easy Belt Replacement
- Confirms with all Safety Regulations

Dimensions

- Belt Outside Radius $C = 87''$
- Minimum Inside Radius $IR_{(min)}$: 36"
- Maximum Between Frame Dimension $BF_{(max)}$: 51"
- Frame Height H : 8.75"
- Shaft Diameter d : 1-7/16"
- Max. Conveyor Angle α : 270°
- Recommended Inclination @ Center Line < 12%

Technical Data

- Speeds up to 600 fpm
- Load 40 lbs./ft.
- Permissible ambient temperature range: -5°F to 130°F
- Active Chain Drive system with loose belt technology to minimize belt wear.

STANDARDS

- DIN EN 619:2011-02 (Continuous handling equipment and systems – Safety and EMC requirements for equipment for mechanical handling of unit loads)
- DIN EN ISO 340:2013-01 (Conveyor Belts – Laboratory scale flammability characteristics – Requirements and test method)
- Machinery Directive 2009/127/EC
- RoHS 2011/65/EU (Restriction of certain Hazardous Substances)
- CE compliant

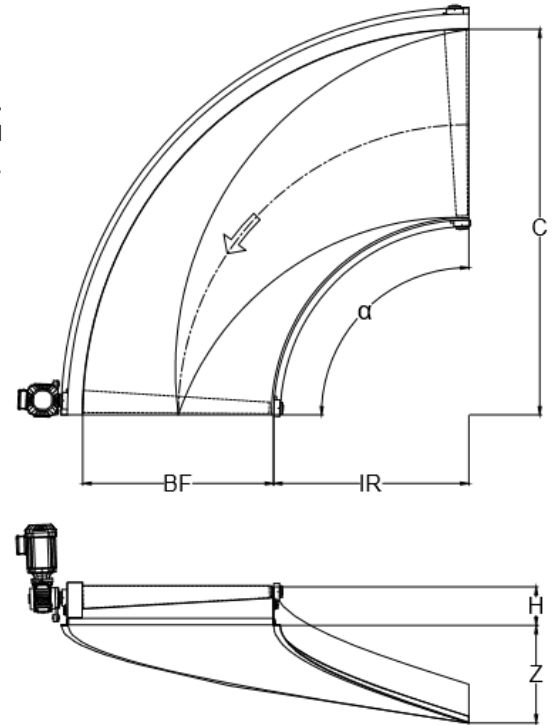

Options

- Removable Inside Frame for Endless Belts
- Stainless Steel Frame
- H-Supports
- Ceiling Hangers
- Product Guards
- Under Guards
- Slider Bed Relief Rollers
- Hand Rails
- Motor at Inside Radius
- Drive via Timing Belt

General

Chain Driven Power Belt Spiral with a Belt Outside Radius C of 2210 mm (BF + IR), especially designed to convey heavy products safely and reliably in an industrial environment such as in the material handling industry, distribution centers, manufacturing industry or airports.

- Tapered End Rollers
- Simple, Efficient and Reliable Design
- Rugged Steel Construction
- Low Maintenance Requirements
- Low Noise Operation
- Easy Belt Replacement
- Confirms with all Safety Regulations

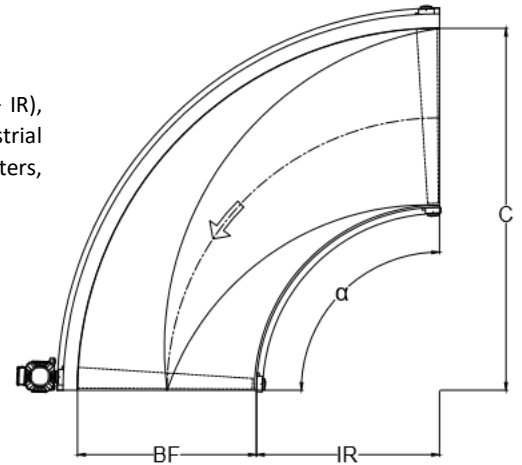

Dimensions

- Belt Outside Radius C = 2210 mm
- Minimum Inside Radius IR_(min): 915 mm
- Maximum Between Frame Dimension BF_(max): 1295 mm
- Frame Height H: 220 mm
- Shaft Diameter d: 35 mm
- Max. Conveyor Angle α : 270°
- Recommended Inclination @ Center Line < 12%

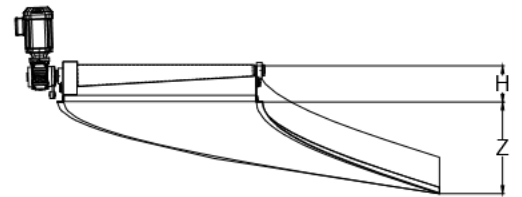

Technical Data

- Speeds up to 3.0 m/sec.
- Load 60 kg/m
- Permissible ambient temperature range: -15°C to 55°C
- Active Chain Drive system with loose belt technology to minimize belt wear.

Options

- Removable Inside Frame for Endless Belts
- Stainless Steel Frame
- H-Supports
- Ceiling Hangers
- Product Guards
- Under Guards
- Slider Bed Relief Rollers
- Hand Rails
- Motor at Inside Radius
- Drive via Timing Belt

STANDARDS

- DIN EN 619:2011-02 (Continuous handling equipment and systems – Safety and EMC requirements for equipment for mechanical handling of unit loads)
- DIN EN ISO 340:2013-01 (Conveyor Belts – Laboratory scale flammability characteristics – Requirements and test method)
- Machinery Directive 2009/127/EC
- RoHS 2011/65/EU (Restriction of certain Hazardous Substances)
- CE compliant