

General

Chain Driven Power Belt Curve with a Belt Outside Radius C of 59" ($BF + IR$), especially designed to convey heavy products safely and reliably in an industrial environment such as in the material handling industry, manufacturing industry, distribution centers or airports.

- Tapered End Rollers
- Simple, Efficient and Reliable Design
- Rugged Steel Construction
- Low Maintenance Requirements
- Low Noise Operation
- Easy Belt Replacement
- Confirms with all Safety Regulations

Dimensions

- Belt Outside Radius $C = 59''$
- Minimum Inside Radius $IR_{(min)}$: 22"
- Maximum Between Frame Dimension $BF_{(max)}$: 37"
- Frame Height H : 8.75"
- Shaft Diameter d : 1-3/16"
- Max. Conveyor Angle α : 270°

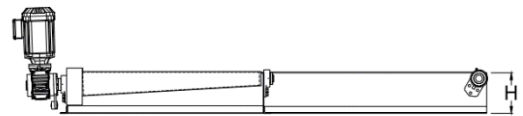
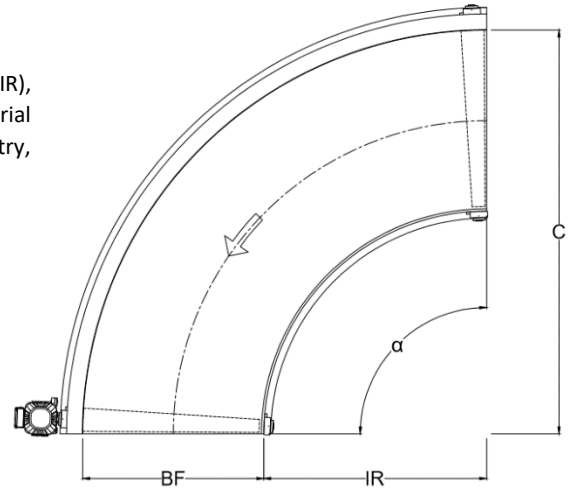

Technical Data

- Speeds up to 450 fpm
- Load 40 lbs./ft.
- Permissible ambient temperature range: -5°F to 130°F
- Active Chain Drive system with loose belt technology to minimize belt wear.

Options

- Removable Inside Frame for Endless Belts
- Stainless Steel Frame
- H-Supports
- Ceiling Hangers
- Product Guards
- Under Guards
- Slider Bed Relief Rollers
- Hand Rails
- Motor at Inside Radius
- Drive via Timing Belt

STANDARDS

- DIN EN 619:2011-02 (Continuous handling equipment and systems – Safety and EMC requirements for equipment for mechanical handling of unit loads)
- DIN EN ISO 340:2013-01 (Conveyor Belts – Laboratory scale flammability characteristics – Requirements and test method)
- Machinery Directive 2009/127/EC
- RoHS 2011/65/EU (Restriction of certain Hazardous Substances)
- CE compliant

General

Chain Driven Power Belt Curve with a Belt Outside Radius C of 1500 mm ($BF + IR$), especially designed to convey heavy products safely and reliably in an industrial environment such as in the material handling industry, manufacturing industry, distribution centers or airports.

- Tapered End Rollers
- Simple, Efficient and Reliable Design
- Rugged Steel Construction
- Low Maintenance Requirements
- Low Noise Operation
- Easy Belt Replacement
- Confirms with all Safety Regulations

Dimensions

- Belt Outside Radius $C = 1500$ mm
- Minimum Inside Radius $IR_{(min)}$: 560 mm
- Maximum Between Frame Dimension $BF_{(max)}$: 940 mm
- Frame Height H : 220 mm
- Shaft Diameter d : 30 mm
- Max. Conveyor Angle α : 270°

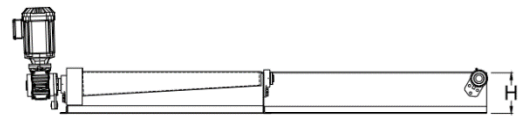
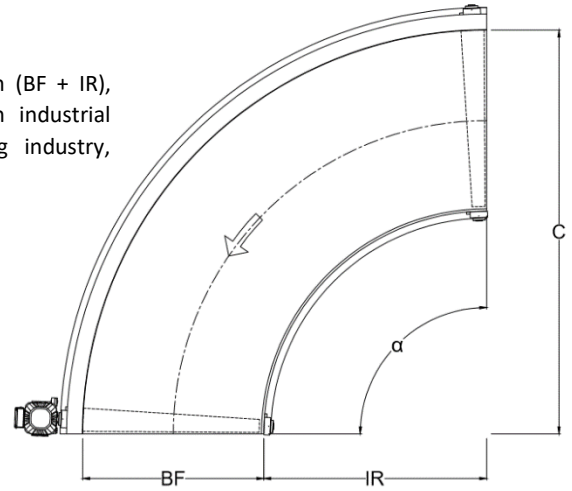
**Technical Data**

- Speeds up to 2.3 m/sec.
- Load 60 kg/m
- Permissible ambient temperature range: -15°C to 55°C
- Active Chain Drive system with loose belt technology to minimize belt wear.

Options

- Removable Inside Frame for Endless Belts
- Stainless Steel Frame
- H-Supports
- Ceiling Hangers
- Product Guards
- Under Guards
- Slider Bed Relief Rollers
- Hand Rails
- Motor at Inside Radius
- Drive via Timing Belt

STANDARDS

- DIN EN 619:2011-02 (Continuous handling equipment and systems – Safety and EMC requirements for equipment for mechanical handling of unit loads)
- DIN EN ISO 340:2013-01 (Conveyor Belts – Laboratory scale flammability characteristics – Requirements and test method)
- Machinery Directive 2009/127/EC
- RoHS 2011/65/EU (Restriction of certain Hazardous Substances)
- CE compliant